

**Technical requirements:**

1. Material: Ductile iron according to the requirements of ISO 1083 for Grade 500/7
2. The surface should be flash, such as cold traps, stomatal, cracks are not allowed
3. The tolerance of matching for covers and frames should be according to the requirements of ISO 8062-CT(1) for grade 10
4. The height of EAC LOGO, SURFACE PATTERNS should be 5mm, and the other embossed words should be 3mm, the draft angle is 10°.
5. Deformation must be according to the requirements of EN124-1994
6. The coating shall be non-toxic water based paint according to BS 3416

				<b>450 × 900 FRAME EN124 B125</b>		长沙金龙铸造实业有限公司	
标记处数		更改文件号		签字		日期	
设计		工艺		图样		N.W 数量比例	
绘图		标准化				16kg	
校对		审定					
审核		日期		2009. 03. 10		共 页 第 页	
						<b>450 × 900-12</b>	

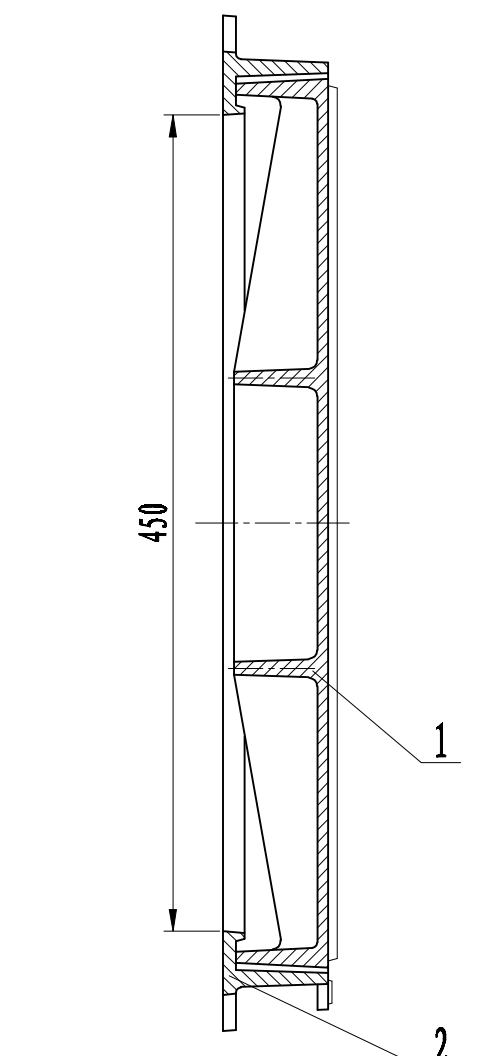
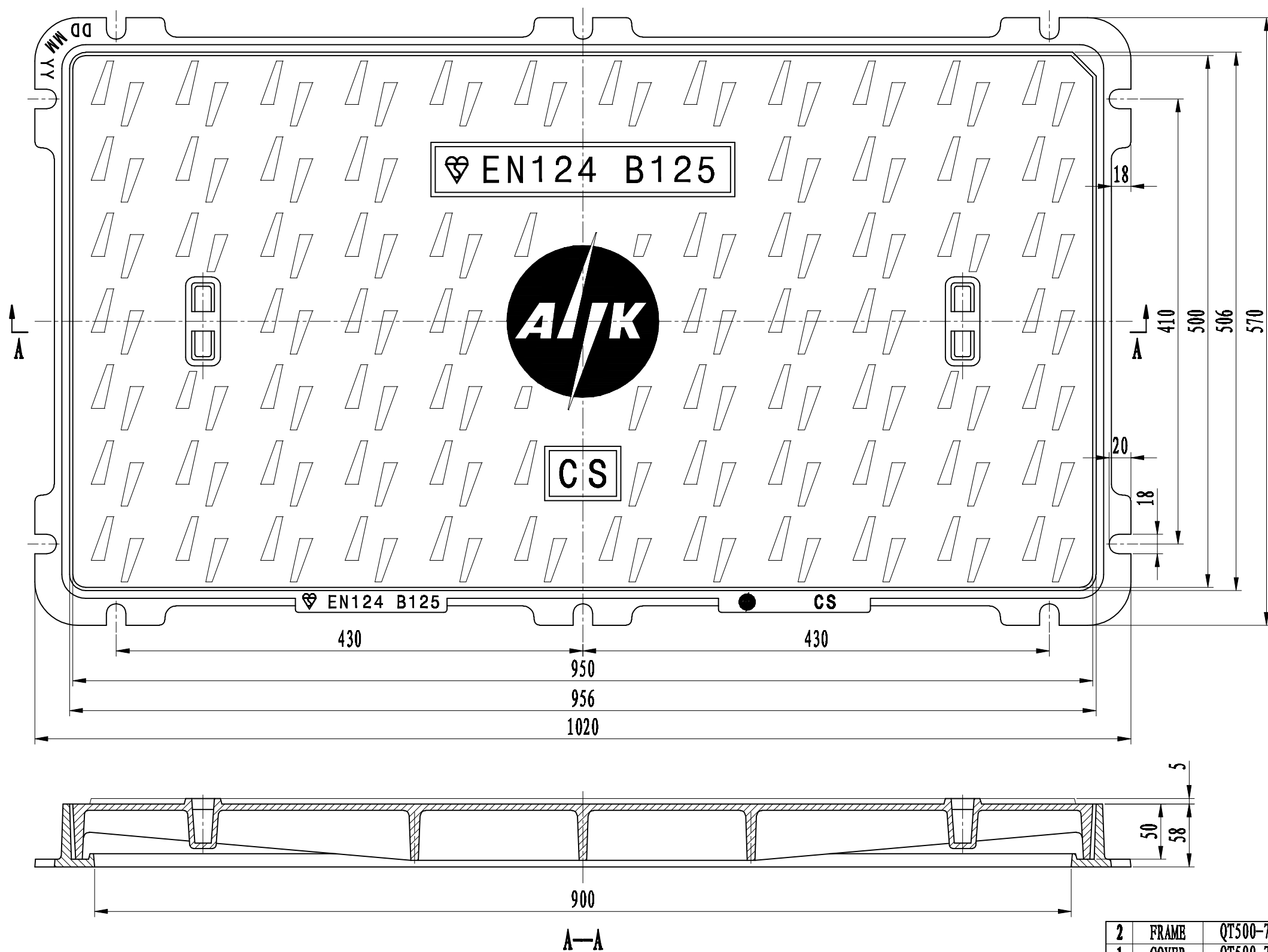

**Technical requirements:**

1. Material: Ductile iron according to the requirements of ISO 1083 for Grade 500/7
2. The surface should be flash, such as cold traps, stomata, cracks are not allowed
3. The tolerance of matching for covers and frames should be according to the requirements of ISO 8062-CT(1) for grade 10
4. The height of EAC LOGO, SURFACE PATTERNS should be 5mm, and the other embossed words should be 3mm, the draft angle is 10°.
5. Deformation must be according to the requirements of EN124-1994
6. The coating shall be non-toxic water based paint according to BS 3416

2	FRAME	QT500-7	1		
1	COVER	QT500-7	1		
序号	名称	材料	数量	规格	备注
				450 × 900	长沙金龙铸造实业有限公司
				EN124 B125	材料 使用设备 QT500-7 制件名称 制件图号
设计		工艺		图样 N.W	数量比例
绘图		标准化		62kg	
校对		审定			
审核		日期	2009. 03. 10	共 页 第 页	450 × 900-10

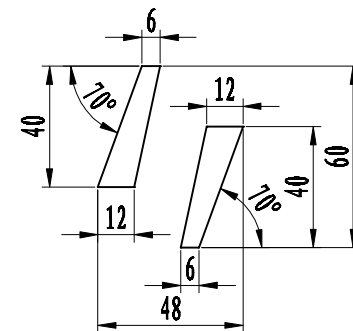
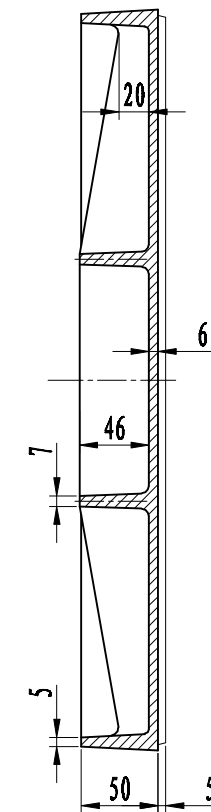
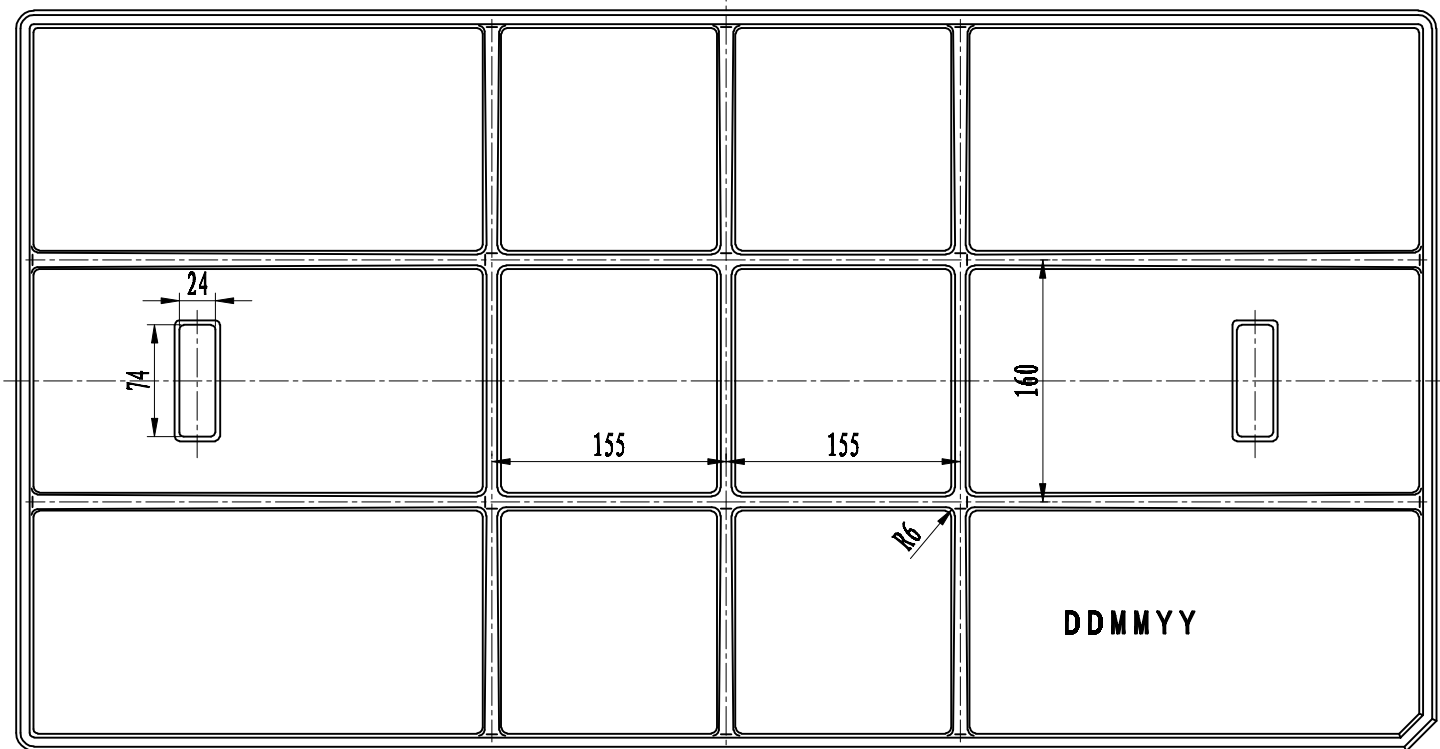
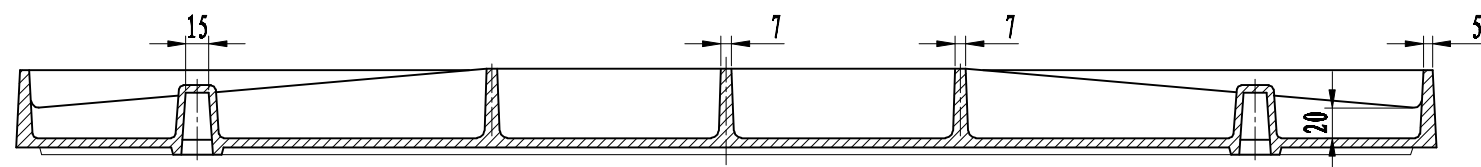
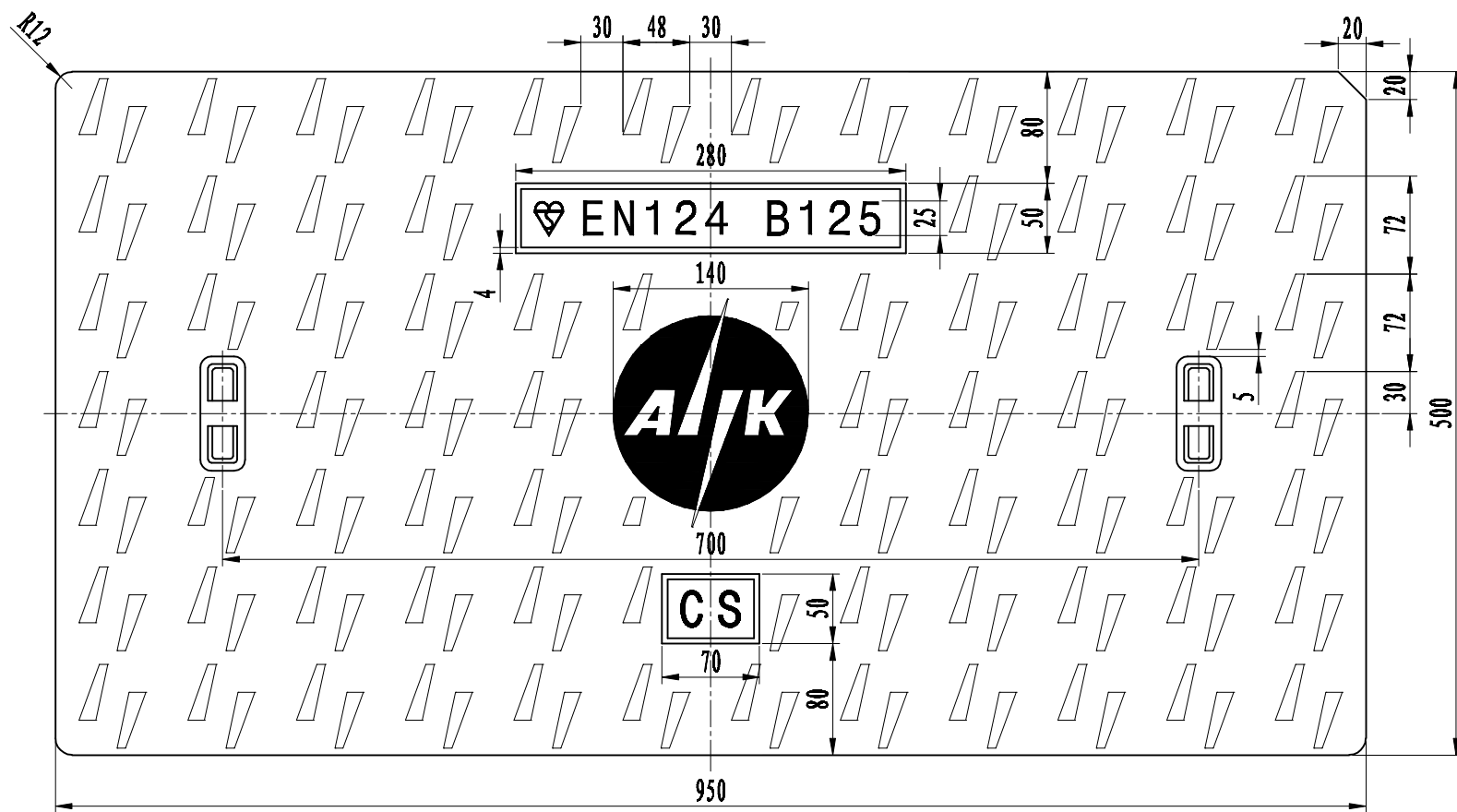

表面花纹

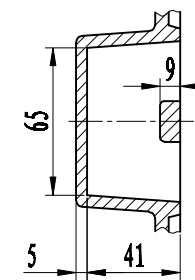
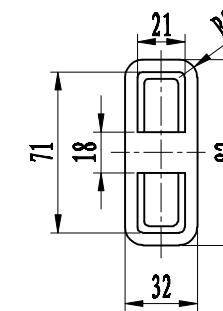

提手孔

Technical requirements:

- 1、Material: Ductile iron according to the requirements of ISO 1083 for Grade 500/7
- 2、The surface should be flash, such as cold traps, stomatal, cracks are not allowed
- 3、The tolerance of matching for covers and frames should be according to the requirements of ISO 8062-CT(1) for grade 10
- 4、The height of EAC LOGO, SURFACE PATTERNS should be 5mm, and the other embossed words should be 3mm, the draft angle is 10°.
- 5、Deformation must be according to the requirements of EN124-1994
- 6、The coating shall be non-toxic water based paint according to BS 3416

				<b>450 × 900 COVER EN124 B125</b>		长沙金龙铸造实业有限公司	
				材料	使用设备		
				QT500-7	制件名称		
				制件图号			
设计	工艺	图样	N.W	数量	比例		
绘图	标准化			46kg			
校对	审定						
审核	日期	2009. 03. 10	共	页	第	450 × 900-11	